







PRODUCTION RANGE



FF CONNECTIONS

	Code	855.03.32*	854.04.32	854.05.32	854.06.32	854.07.32	854.08.32	854.09.32
	Size	3/8"	1/2"	3/4"	1"	1 1/4"	1 1/2"	2"
	PN [bar]	50			40	30	25	
	Code	855.03.42*	854.04.42	854.05.42	854.06.42	854.07.42	854.08.42	854.09.42
	Size	3/8"	1/2"	3/4"	1"	1 1/4"	1 1/2"	2"
	PN [bar]	50			40	30	25	
	Code	989.03.32*	989.04.32	989.05.32	989.06.32	989.07.32		
	Size	3/8"	1/2"	3/4"	1"	1 1/4"		
	PN [bar]	50			40	30		

MF CONNECTIONS

	Code	886.03.32*	886.04.32	886.05.32	886.06.32	886.07.32	886.08.32	886.09.32
	Size	3/8"	1/2"	3/4"	1"	1 1/4"	1 1/2"	2"
	PN [bar]	50			40	30	25	
	Code	886.03.42*	886.04.42	886.05.42	886.06.42	886.07.42	886.08.42	886.09.42
	Size	3/8"	1/2"	3/4"	1"	1 1/4"	1 1/2"	2"
	PN [bar]	50			40	30	25	
	Code	887.03.32*	887.04.32	887.05.32	887.06.32	887.07.32		
	Size	3/8"	1/2"	3/4"	1"	1 1/4"		
	PN [bar]	50			40	30		

MM CONNECTIONS

	Code	885.03.52*	885.04.52	885.05.52	885.06.52			
	Size	3/8"	1/2"	3/4"	1"			
	PN [bar]	50				40		
	Code	885.03.32*	885.04.32	885.05.32	885.06.32			
	Size	3/8"	1/2"	3/4"	1"			
	PN [bar]	50				40		
	Code	885.03.42*	885.04.42	885.05.42	885.06.42			
	Size	3/8"	1/2"	3/4"	1"			
	PN [bar]	50				40		

* Full bore

CONSTRUCTION CHARACTERISTICS

Body	: Brass nickel plated	Rod	: Brass
Ball	: Brass	Rod guide	: PTFE
Seal	: PTFE	Auction ring	: Brass
O-ring	: EPDM	Lever	: Aluminium/steel, painted red color
Hat	: Brass	Butterfly	: Aluminium, painted red color
Threaded conn.	: UNI-EN-ISO 228	Passage	: Standard for 1/2" ÷ 2" Full bore for 3/8"

TECHNICAL CHARACTERISTICS

Temp. range : -20 ÷ +120°C
 Working P_{max} : see above indication

Usable fluid : water

DIMENSIONAL CHARACTERISTICS

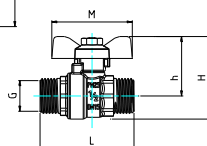
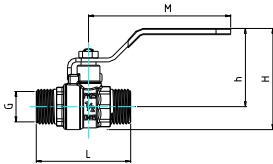
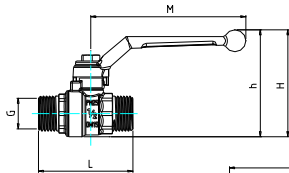
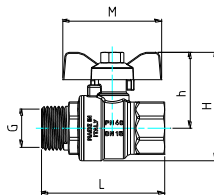
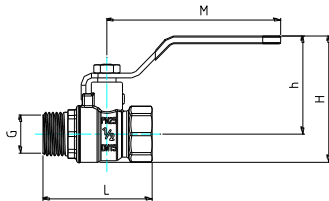
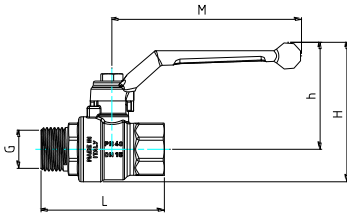
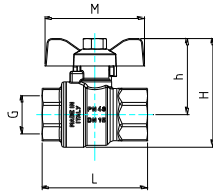
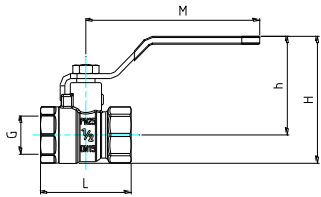
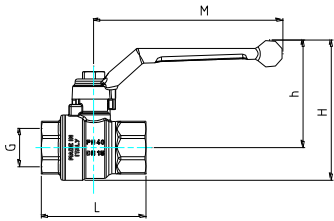

Code	Measure G	L [mm]	h [mm]	H [mm]	M [mm]	Kv (m³/h)
855.03.32	3/8"	42,5	48,6	59,2	92,0	-
854.04.32	1/2"	44,0	51,0	64,0	92,0	13,23
854.05.32	3/4"	52,0	54,0	61,5	92,0	23,84
854.06.32	1"	63,0	61,8	86,5	117,0	40,36
854.07.32	1 1/4"	70,0	65,1	89,6	117,0	47,67
854.08.32	1 1/2"	81,0	90,2	122,3	176,0	105,25
854.09.32	2"	97,0	97,0	136,0	176,0	185,00

855.03.42	3/8"	42,5	44,6	55,2	84,4	-
854.04.42	1/2"	44,0	47,0	60,0	84,4	13,23
854.05.42	3/4"	52,0	50,0	67,5	84,4	23,84
854.06.42	1"	63,0	60,8	85,5	102,2	40,36
854.07.42	1 1/4"	70,0	64,1	88,6	102,2	47,67
854.08.42	1 1/2"	81,0	82,2	114,3	152,4	105,25
854.09.42	2"	97,0	89,0	128,0	152,4	185,00

989.03.32	3/8"	42,5	31,8	43,4	50,0	-
989.04.32	1/2"	44,0	35,3	48,8	50,0	13,23
989.05.32	3/4"	52,0	39,0	56,4	50,0	23,84
989.06.32	1"	63,0	43,6	65,3	70,0	40,36
989.07.32	1 1/4"	70,0	47,4	71,9	70,0	47,67

886.03.32	3/8"	55,0	48,6	59,2	92,0	-
886.04.32	1/2"	53,0	51,0	64,0	92,0	13,23
886.05.32	3/4"	63,0	54,0	61,5	92,0	23,84
886.06.32	1"	73,0	61,8	86,5	117,0	40,36
886.07.32	1 1/4"	83,5	65,1	89,6	117,0	47,67
886.08.32	1 1/2"	95,5	90,2	122,3	176,0	105,25
886.09.32	2"	113,0	97,0	136,0	176,0	185,00

886.03.42	3/8"	55,0	44,6	55,2	84,4	-
886.04.42	1/2"	53,0	47,0	60,0	84,4	13,23
886.05.42	3/4"	63,0	50,0	67,5	84,4	23,84
886.06.42	1"	73,0	60,8	85,5	102,2	40,36
886.07.42	1 1/4"	83,5	64,1	88,6	102,2	47,67
886.08.42	1 1/2"	95,5	82,2	114,3	152,4	105,25
886.09.42	2"	113,0	89,0	128,0	152,4	185,00

887.03.32	3/8"	55,0	31,8	43,4	50,0	-
887.04.32	1/2"	53,0	35,3	48,8	50,0	13,23
887.05.32	3/4"	63,0	39,0	56,4	50,0	23,84
887.06.32	1"	73,0	43,6	65,3	70,0	40,36
887.07.32	1 1/4"	83,5	47,4	71,9	70,0	47,67

885.03.52	3/8"	58,6	48,6	59,2	92,0	-
885.04.52	1/2"	56,0	51,0	64,0	92,0	13,23
885.05.52	3/4"	65,0	54,0	61,5	92,0	23,84
885.06.52	1"	77,0	61,8	86,5	117,0	40,36

885.03.32	3/8"	58,6	44,6	55,2	84,4	-
885.04.32	1/2"	56,0	47,0	60,0	84,4	13,23
885.05.32	3/4"	65,0	50,0	67,5	84,4	23,84
885.06.32	1"	77,0	60,8	85,5	102,2	40,36

885.03.42	3/8"	58,6	31,8	43,4	50,0	-
885.04.42	1/2"	56,0	35,3	48,8	50,0	13,23
885.05.42	3/4"	65,0	39,0	56,4	50,0	23,84
885.06.42	1"	77,0	43,6	65,3	70,0	40,36



RBM reserves the right to make improvements and changes to the products described and to their technical details at any moment and without notice: always refer to: the instructions enclosed with the components supplied; this sheet is an aid if they prove to be too schematic. Please contact our technical office for any doubts, problems or clarification.

rbm
 RBM Spa
 Via S. Giuseppe, 1
 25075 Nave (Brescia) Italy
 Tel. 030-2537211 Fax 030-2531798
 E-mail: info@rbm.eu - www.rbm.eu